

Upton St Leonards Life

incorporating Church News

Issue 81

May 2021



Lockdown Eases as we Spring into Summer The World really is Open for Business from 17 May

1. Up to 30 people can meet outdoors, attend weddings and other life events
2. 6 people or 2 households can meet indoors
3. Domestic overnight stays allowed, outside own family or bubble
4. Hotels, restaurants and social clubs to fully open
5. Adult indoor group sports & exercise classes restart
6. Theatres, children's play areas and cinemas can open
7. Large events can restart, but with limits on audience numbers
8. International leisure travel may resume

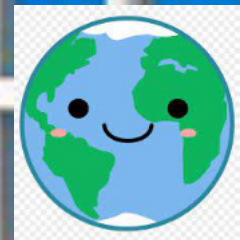

YOUR VOTE MATTERS

DON'T LOSE IT



Elections taking place on

Thursday, 6 May - 7am - 10pm

- O Police Crime Commissioner
- O Council Election: Bisley & Painswick
- O District Election: Painswick & Upton
- O Parish Election: Upton St Leonards

Polling station:

Upton St Leonards Village Hall
10 Bondend Road
GL4 8AG



At Last!

Brian and Lorraine, our new stewards (the two standing in the picture) welcome their first eager customers. See page 7 for more information.

3 May - Early Bank Holiday

31 May - Spring Bank Holiday



Parish Council Annual Reports p 4-6
Upton Show p 8
Churchyard Update p 13-14
Feature Article p 15
Spring & Health p 17

Editorial



We are all proud to live in our lovely village but are our roads and pavements in need of repair? Are our street signs in urgent need of attention? Rotting wood, faded lettering and some close to being illegible, are just some of the examples as shown in the pictures below.



Walking around our village on a daily basis it is sad to see so many of our village roads and cul-de-sacs in such a poor state of repair due to decades of neglect; tarmac erosion on pavements and kerbsides clearly evident,

especially in Six Acres, with only rubble and grit in its place.

Nut Hill after being closed for nearly three months has had the usual 'token' man and a bucket job on the ever increasing number of potholes. At the last count, there were 40 plus remaining in need of immediate attention.

Can we urge the Parish Council to look into these matters on our behalf in addition to the excellent work they have carried out locally and to work with the County Council to address these defects?

A concerned resident



The USL Life monthly newsletter is produced by a registered company. For the type of company we are, we need to have "members". It is the members who vote at the AGM, elect the board and chairman, and so, ultimately, members control the company. Members are also liable

up to an amount, not exceeding £1, should the company be wound up in some way with outstanding debts. Our constitution requires that memberships are renewed every 3 years, and we last did this in 2018. There is no membership fee.

Anyone can be a member, but you won't be surprised to know that we have only a very few people signed up as members, except those involved in its production and distribution. We do, therefore, rely heavily on those in our production and distribution team for the bulk of our membership. For further details please contact Andy Russell on 07776 341333



Gill Howell was licensed as our Churchwarden on Sunday, 4th April.

She has been carrying out the Church Warden duties for a few months but this was the first occasion that they could license her and it was a



fitting tribute at the end of our Easter Sunday service.

James Turk gave Gill the bouquet as a thank you for all her hard work!



Many thanks to the people who have left wool on my doorstep. I never seem to be home when the gifts arrive, but I can assure you the wool will be used to make garments for the Family Haven in Gloucester.

From Rachel Hall

Brothertons
Accountants & Tax Advisors

Personalised, friendly service to local business owners and individuals

All Aspects of Accountancy:

- Self Assessment Tax Returns
- Sole Trader Accounts
- Limited Companies
- VAT
- Payroll
- Bookkeeping

*Local family firm
Established 1998
Free initial meeting
Fixed quotes*

2 Abbeymead Avenue, Gloucester GL4 5ER
01452 311711
www.brothertons.co.uk
email info@brothertons.co.uk

  *Fast, Friendly & Dedicated Service In Your Local Area*

Family Run Business Est. In 1968

CEDAR MOTOR HOUSE LTD

Grove Court, Upton Hill
Gloucester GL4 8DA
01452 617240 or 07976 322735

MOT TESTING WHILE YOU WAIT FOR PETROL AND DIESEL VEHICLES

Diagnostic Fault Code Reading.
Vehicle Servicing & Mechanical Repairs.
Clutches & Timing Belts Replaced, Top Quality Tyres, Batteries & Exhausts Fitted AT Competitive Prices.
Insurance & Accident Repairs.
Welding Service.

Servicing for New & Used Vehicles Using Genuine Parts If Required, at Much Lower Rates than Main Agents. All Parts and Repairs Complying with Manufacturers Warranty Requirements.
Lube Service from £89 incl VAT
Interim Service from £129 incl VAT
Full Service from £175 incl VAT

We are situated on Upton Hill in Upton St Leonards. Grove Court is 100 yards past the Kings Head Pub on the right hand side. Collection service available.

Your qualified village electrician

 **MJBoon**
Electrical

☎ 07773 626241
✉ matt@mjboonelectrical.co.uk
🌐 www.mjboonelectrical.co.uk

- Free estimates and advice
- All aspects of electrical work undertaken

 **DOMESTIC INSTALLER** 

What's Been Happening in Upton?

From 2nd – 18 April, the schol PTA organised an Easter Trail around the village. Eighteen residents participated in



decorating their windows and gardens, all showing an amazing array of ideas and interpretations of the Easter theme.

No fewer than six families in Woodland Green, as well as those in Staites Orchard, Twyver Close, Perry Orchard, Churchfield Road, The Pinlocks, High Street and Kennett Gardens entered into the spirit of

things and demonstrated a great community spirit in supporting this fundraising event. All monies raised are going towards the construction of playground equipment at the school.



One lucky family, deemed to be the winner of the best entry, will be the beneficiary of the rather splendid hamper below, courtesy of Gavin Jones, from Bowden Hall.

Upton School Story Competition

Last month we printed the winning entry, from the short story competition based around lockdown. This month you can read a letter to a friend by Jason Clutterbuck, who gained second place.

Dear Charlie

I just thought I would write to you as we haven't spoken for a while and it would be nice to speak to each other.

I have been doing home schooling again for the last two months whilst we have been in lockdown. It has been very hard and I find it difficult to concentrate on school work at home. My mum and dad have helped me when they can, but they

are both key workers, so sometimes I just do my best, but it gets boring and I find myself just raiding the fridge for food.

I have found myself getting very angry and upset some days. I'm not sure why. I guess it's because every day is just the same lately. The weather during this lockdown hasn't been the best either. It's been cold, wet and not much fun outside, although we have had a few snowy days, which was fun. We went sledging and had a snowball fight. We have been on lots of walks with my family and my dog. The muddy walks have been the best. What's the weather like where you are?

Both sets of my grandparents have had their first Covid injection to help protect them from the coronavirus. I felt worried about them having it but I suppose it means that I can visit and hug them very soon.

So it's back to school on Monday which hopefully means no more home school ever! I just can't wait for life to be back to normal again!

I hope everything is OK with you. What have you been up to during the lockdown? Hopefully hear from you soon.

Take care, Jason

Well Done to all the USL Peaks Challenge Achievers!!



A special thank you to Stewart Tedaldi and Nutty Badgers for providing us with the USL Peaks Challenge. By early April over 500 Waypoint check

ins had been registered and by the Easter weekend, the 50th person had completed the Ultimate Challenge!

These peaks have clearly inspired so many, young and old (I know at least half a dozen 'over seventies') that have risen to the challenge. So whether you run or walk, it matters not; improving your fitness is what really counts!!!

What has also been so invigorating has been venturing to different parts of our locality and encountering families of deer, flying barn owls and spectacular views; also the opportunity to test out the map reading skills once more, using

traditional OS maps or those downloaded onto our phones.



It has brought a lot of joy and a real sense of achievement to both individuals (myself

included) and families alike, judging by the comments left on the USL Community Facebook Page, so thank you once again.

Andrea Dawson

For more information visit: www.daveylaw.co.uk

**DAVEY
- LAW -**

Solicitors

FOR YOU

YOUR FAMILY

YOUR BUSINESS

Always here to assist you, your family, and your business

- Residential Property
- Wills & Probate
- Lasting Powers of Attorney
- Family & Divorce
- Inheritance Tax Planning
- Employment Law
- Dispute Resolution
- Commercial Property
- Clinical Negligence
- Personal Injury

Gloucester: 01452 508800 | Cirencester: 01285 654875

enquiries@daveylaw.co.uk

**N.T. Boothroyd
Plumbing & Heating
Est. 1986**

**All Plumbing & Heating Work
Undertaken & No Job too small !
Boiler & Fire Servicing
Central Heating Systems
Landlord Certificates, etc.**

**Glos: 01452 552192
Chelt: 01242 250497
Mob: 07816 103709
ntboothroyd@hotmail.co.uk**



USL Parish Council Annual Report 2020/2021

Chairman's Report: Cllr Keith Pearson

Who would have thought that this time last year I would be writing my annual report again whilst in another national lockdown due to the Covid 19 pandemic, but here we are. This has undoubtedly been a year like no other in most of our lifetimes. At least at the moment we do have a light at the end of the tunnel now we have a vaccine.

The Parish Council has continued to carry out its work however and has been meeting regularly albeit now on Zoom meetings, something we have all got used to. Our Clerk has done sterling work in organising everything whilst working from home for which we are appreciative. Liaising with the District Council has been more difficult as they have all been at home too.



I would like to pay tribute to all the local people who volunteered to help with the support group that was set up at the start of the crisis, they worked as a great team helping those that needed assistance with shopping and getting their medication etc.

I also mustn't forget the great service given by our two local shops. Thank you all. I hope we are all able to get back to some form of normality in the very near future and we see the Village Hall, Church and the BMI club at the heart of the village thriving once more.

Planning Report: Cllr Chrissie Castle

There were 40 formal applications for planning in the parish this year and all were applications for extensions/modifications to homes except for 3 tree applications which had Tree Preservation Orders (TPO) on them. We have seen a few more applications from the Coopers Edge side of the parish, mainly involving minor alterations and we would expect a few more of these in the future as the properties become older and more established.

To date there has been no update on the development at Bowden Hall Farm by Dawn Homes. We keep in contact with them but have not been notified of any dates for development to start.

In the current crisis it has become more than apparent how vital the AONB is for both leisure and agricultural use. New footpaths have been created and as such the preservation of the AONB is more important than ever as more people enjoy the local countryside. The PC is strongly supportive of retaining a tightly drawn settlement boundary and restricting further development to occasional infill within the defined settlement. The Parish response to the SDC draft local plan review

supported this view and for residents interested in following the process and wishing to find out more visit: www.stroud.gov.uk/localplanreview.

We have had a few instances where prior to putting in an application people have initially asked for the PC's comments. We would always recommend that you first pay for a pre-application to the planning department at Stroud who can give the best advice and then when it comes to the PC, we can then give comments. There is a cost for this service by SDC, but it is better and cheaper than having the full planning application turned down. This is of particular use when full plans are required for a large project.

Planning meetings are still held on the first Monday of each month prior to the Parish Council Meetings and have continued throughout the lockdown via Zoom, which have been used as a temporary measure. The public can always attend and can ask for a link by contacting the Secretary to the PC Roy Balgobin. For more information on planning applications, you can register on the planning portal website and you will automatically be updated with any new applications in your area.

Environment Report: Cllr Peter Wilson

I consider the environment of our village to be more than the physical. In my opinion, it also includes our community spirit and activities. During the last challenging 12 months, it has been great to see lots of examples of neighbours supporting each other and initiatives like setting up of the Village Helpline, which proved so important in getting food and medicine to those who were unable to travel in the early days of lockdown. The Post Office/Shop also played its part.

Our normal activities such as village maintenance have continued (eg grass cutting, monthly litter picks etc) thanks to our Parish Clerk, Roy, who beavers away for our benefit in the background.



Due to the lockdowns we have experienced, many of the local clubs and social events haven't taken place so we look forward to a time when the weekly/monthly/annual events can resume in 2021 with all the social interaction that comes with them.

As a Council, we continue to make improvements to our village and over the last year have, with the support of others, completed the following:

- Refurbishing the Pavilion (new seats, carpets, showers and a defibrillator)
- New Picnic Benches for the Recreation Ground
- Play Equipment for pre-school children installed at the Recreation Ground

Cont'd on page 5

Parish Council Annual Report cont'd

Environment Report: Cllr Peter Wilson cont'd

- The Village Green Memorial Bench and plaques were refurbished
- New Village Signs installed at each end of the village
- Put up Speed Limit signs to encourage safe driving
- Several new Footpaths created (down to the efforts of our Footpath Team)
- Sited a Defibrillator in the old Phone Box by the Village Hall
- Successfully bid for Tree Planting from The Woodland Trust (due late April)

As a result of the significant rainfall and homeowner problems experienced in December, we are looking at what can be done to improve flood prevention in Upton with the relevant bodies.



Tony Pryce and the M5 Working Group continue to work on how the motorway noise can be moderated but their task is difficult (involving MPs and Government Departments). We wish them well in their efforts and will continue to support the group in whatever way we can.

It is fair to say, this year during long periods of lockdown, more local people have been exploring the lovely walks we have on our doorstep and hopefully the efforts of our weekly Footpath Team are more appreciated than ever. The latest edition of our village walks booklet and online guidance from The Nutty Badgers Explorers Scout Group have proved very useful to many.

I would like to finish by thanking those people who help every year to make Upton a great place to live and to the Newsletter Team and contributors who have ensured USL Life has been

created and distributed during difficult times to provide some light relief and information!

Recreation Report: Cllr David Hunt

A most difficult year at the Recreation Ground with the Pavilion closed and organised sports on hold during the many months of virus induced 'lock-down'. However, during this on-going period the Rec. and Glebe Field have remained 'green and pleasant' and open for essential outdoor exercise, so long as Government guidelines were strictly observed.

With national restrictions being gradually lifted, a controlled return to normality is hoped for during the forthcoming months. Constantly updated Government guidance is giving details of how this might apply. One unexpected advantage, during the restrictions on travel, was a much quieter motorway with much reduced noise and air pollution at the Recreation Ground, reinforcing the Parish Council case for a permanent solution to this problem. The issue is being actively pursued, now with the help of our MP, Siobhan Baillie.

Whilst increased informal use of the two fields has seen some increase in litter, this has been nowhere near as bad as in some other public locations. Well done USL ! - keep up the good practice. Increased footfall during the very wet periods has meant that the main pedestrian entrance points had become very muddy and this has been combatted with additional hardcore and gravel at these sensitive locations. One unfortunate side effect of the increasing popularity of the Glebe Field dog walking facility (informally promoted on social media networks) is increased car parking pressures in the main car park at peak times but also affecting Oldway Lane, on occasions, blocking the entrance to Glebe and Rec and obstructing access to adjacent properties. The Council hopes that this will be resolved when ...

cont'd on page 6

A1 Windows
"for all your window needs"
A local friendly company with over 35 years experience

- Replacement uPVC & aluminium windows, doors and conservatories made to measure
- Replacing misted glass
- Locks
- Hinges
- Handles
- Patio rollers
- Coloured Composite Doors made to measure

Free no obligation quotations
www.a1windows-gloucester.com

Simon Green
01452 535811
07989 891227

John Weygang
OPTOMETRIST

Your local practitioner, providing the highest quality eye care, including **FREE NHS Eye Tests**, specialised products and services for you and your entire Family

Please contact our Churchdown practice if you would like to arrange a Home visit

LOCATIONS - ABBEYMEAD 01452 306807
CHURCHDOWN 01452 855484 | GLOUCESTER 01452 522118
HUCCLECOTE 01452 619300 | QUEDGELEY 01452 721108
www.weygang.co.uk

David Cridland Contracting

Fencing, Ground maintenance and groundwork contractor

3 Ton mini-digger with driver available

All types of fencing supplied and erected.
Hedges cut. Trees pruned. Ground cleared.
From small gardens to farms, no job too small.
Service and reliability guaranteed

Fully insured 20 years experience

01452 311215 or 07836 279974
COMMELINES MILL FARM
UPTON ST LEONARDS GL4 8EG

Parish Council Annual Report cont'd

Recreation Report: Cllr David Hunt cont'd

..... Covid restrictions are removed but the matter will be kept under close review. A further improvement during what would have been the football season was the introduction of a 'container' unit in a discreet, screened location near the cricket nets, the main purpose being to house safely, essential equipment associated with the football pitch and its maintenance.

Taking advantage of the lockdown, the PC and club members have been undertaking modifications and improvements to the changing rooms and wash facilities which we will be able to appreciate on reopening. At this point I would like to thank Andy Russell our Pavilion Manager together with all those volunteers who assist, on an unpaid basis, with general maintenance in and around the grounds - a tremendous service that is much appreciated.



Looking ahead and planned for the spring (hopefully irrespective of the Covid situation) is a much needed resurfacing of the car park. Apologies in advance as there will be some inconvenience for a few days whilst work is in progress. In addition, a substantial tree planting scheme is planned for parts of the Glebe Field (see Environment Report for further details).

Finally, in reviewing this, the strangest of years, mention must be made of a new and unforeseen use of the Rec - as an airstrip! A recent medical emergency required the air ambulance helicopter to make a landing in Upton. An early evening touchdown was made on the edge of the cricket square. Subsequent checks showed no damage to the pitch. When interviewed the pilot remarked that he could not have found a better place to land.

Allotment Report: Cllr Hilary Morris

It has been another good year for the allotment sites in the village despite some very bad weather. We have to say that both sites are looking very good, the effort that people have put in to them is amazing. We have to thank the two site managers, Holly Paton who manages Perry Orchard site and Peter Macey who manages the Stanley site, for the continued support to both sites. They do the work quietly and efficiently, often without people realising the effort they have put in. The Parish Council thank them for their continuing efforts in these difficult times, considering these are voluntary positions.



To all tenants, the renewals will be sent out as soon as we are able. We would ask all tenants to read the agreement they receive and to observe the rules. There have been occasions where alterations and changes have been made without first discussing with the site managers or the Parish Clerk. This causes unnecessary bad feelings which could have been avoided.

All tenants, thank you for all the hard work you put in and I hope 2021 is a bountiful year. This is reflected in the way the two sites always look so impressive. A reminder that you will be able to pay by BACs should you prefer this method of payment.

Please be careful when attending the allotments and continue to observe the notices that have been posted at both sites and observe the distancing regulations. Hopefully we will all be able to get back to closer contact very soon with our families and friends as restrictions are gradually lifted.



"This to confirm that all existing Parish Councillors have been re-elected unopposed for the next 3 years".

Rhys James Fencing

All types of fencing and gates supplied & fitted. From minor repairs to complete new fence, I offer a fast & friendly service.

Local contractor, fully insured, established over 20 years.

Garden work undertaken. Trees removed, stumps ground, hedges cut. All waste responsibly disposed of.

The Lodge Rance Pitch Upton St Leonards

07931 380463 / 01452 372051
rhysjames64@outlook.com
and on facebook

Approved Contractor, to Local social housing Association and the Diocese of Gloucester

The BMI Club logo is a shield-shaped crest. The top half is yellow with the letters 'B M I' in blue. The bottom half is blue with the year '1898' in yellow.

The BMI Club
(Est 1898)
Bondend Road
Upton St Leonards

Members Club, new members welcome.

Two bars, wide screen TV with Sky/BT Sports. Snooker /Pool Tables. Skittle Alley.
Regular entertainment nights.
Function room hire.

Annual Fee £10 plus £5 joining fee.
Senior Citizens half price

To join just call in and see Brian our Steward for details.
Open Mon-Fri lunchtimes & evenings.
Sat-Sun Open all day.
<http://www.bmiclub.co.uk/>
Tel. 01452 616384

MOG'S HAPPY DAYS PRIVATE HIRE
"Why drive when you can be driven?"

LEWIS MORGAN
Chauffeur

07814 947587
lewismorgan58@live.co.uk

Hi! I'm Lewis Morgan, Gloucester born and bred family man. I've been driving safely for 40 years.

Independent Private Hire for up to 4 persons plus ample luggage space.

UK Holiday destinations, Airports, Weddings and Parties. Cheltenham and Chepstow races, shopping trips, hospital appointments.
OAP discount.
Just ask for what you need and see if I can help!

07814 947587
www.mogshappydaysprivatehire.co.uk

The BMI Re-Opens

The BMI opened for outside service on April 12. It was a great day, albeit cold, with many members having their first pulled pint for months. A whole barrel of the guest ale was downed on that first day. I can vouch for how great it tasted!

Possibly the happiest people there were Brian and Lorraine Dodd, the steward and his wife, who arrived here last November and have not had a single customer until April 12. At last they could meet and serve the locals! It must have been a very lonely wait. Time not wasted of course - they've re-decorated and laid things out a bit differently. Right from the off, they've done

some catering, and one can already have various filled rolls and toasties. The menu will gradually develop as Brian and Lorraine get a feel for what customers want. They have quite a few ideas - maybe fish & chip days, a curry night, even Sunday lunch. They've already taken a booking or two for parties later in the year.

If the Covid restriction lifting stays on schedule, we will be allowed indoors from Monday May 17, in limited numbers, sitting at tables. From June 21 remaining restrictions are due to be removed. Between now and then, the committee will be reviewing the

current rule of members only, so that guests can be accommodated as well - perhaps at times when it isn't busy.

The coffee club will restart as soon as it is practicable, as will bingo nights, quiz nights and days at the races.

Do go along and have a drink and maybe a snack (but still members only at the time of writing this) - make Brian and Lorraine feel welcome.

Andy Russell

Twyver WI

The group continues to have monthly talks via Zoom, which have been very well attended. April's talk by Joanna Gardiner was about Medical Detection and Medical Alert Assistance Dogs. The latter provide people with confidence, quality of life, independence, freedom, a reduction in the need for hospital visits and ultimately save lives.

Sadly, space does not permit any further information on this talk but all attendees agreed that it was one

of the best talks we have ever had, given by such a passionately informed speaker. Further details can be found on www.medicaldetectiondogs.org.uk Our speaker for 10 May is Richard Rickitt on the subject of Bee Craft. Members from both WI groups are most welcome to attend this Zoom meeting. Contact Millie Barnes for further information.

Monthly walks will resume from 6 May, in line with Government guidelines for Twyver WI



Upton WI

It is to be expected

that face to face meetings will restart in July for both groups.

GFWI

The last of the monthly quizzes took place on 8th April, producing joint winners, after additional questions to ascertain a winner. In the end both Jane Hey from Frampton and Lynne Burns from Bishops Cleeve and the Shires agreed to share the glory. Congratulations to both for some impressive scoring.

Little Court Cottages

Cottages for long rent, and self-catering accommodation for short breaks, in Upton St Leonards, perfect for visiting friends and family.

Email: info@littlecourtcottages.co.uk

Tel: 01452 615150

www.littlecourtcottages.co.uk



Do you need help around your home?

"Being local, I'm a very Handy Man!"

With over 30 years experience, here are just some of the jobs that I can do to help you improve and maintain your home.



Tiling

SPECIALIST



Bathroom installations



Hall, stairs & landing



Painting & decorating

Friendly, Caring, Trustworthy Service from a Friendly, Caring Person at Really Friendly Prices.

For a FREE quotation please ring me, David Holder on

Tel: 01452 611866 Mobile: 07977 099996 or Email: holdermaxine@aol.com

DJH Home Services, Gloucester Established 1984

Upton Show

Saturday, 11 September 2021

Hopefully the coronavirus will not prevent the show from going this year!

Below is a further section of the schedule which includes the children's classes
This will give time to practise their entries

This will give time to practise their entries!



SECTION "H" - CHILDREN

Children can only enter classes in their correct age group
Age of child as at 31st August 2021 to be quoted on all entry forms

All class prizes 1st - £5, 2nd - £2, 3rd - £1 kindly donated by the Lady Downe Trust

Group 1 – Under 5 years

Class

- 187 A hand print of a tree (max A4)
- 188 Make a face on a paper plate

Group 2 – Ages 5 – 7

Class

- 189 A collage with a flower theme (max A4)
- 190 Make 4 pieces of "rocky road" (using a favourite recipe)
- 191 Make a vegetable monster
- 192 Make a potato print pattern
- 193 A drawing or painting of your favourite animal (max A4)

Group 3 -Ages 8 – 11

Class

- 194 An origami bird
- 195 An item made from a craft kit
- 196 A colour photo "Having Fun" - max 7" x 5"
- 197 5 fairy cakes decorated with a Halloween theme (using a favourite recipe)
- 198 A drawing or painting entitled "A Seaside Holiday" (max A4)
- 199 A decorated trainer
- 200 Handwriting – write your **favourite joke** in your best handwriting

Group 4 – Ages 12 – 16

Class

- 201 3 gingerbread people, decorated with icing (use a favourite recipe)
- 202 A colour photo "Wildlife" - max 7" x 5"

- 203 A drawing or painting entitled "Bonfire Night" (max A4)
- 204 Design an outfit for a "Strictly Come Dancing" celebrity (max A4)
- 205 Make a felt animal
- 206 Write a short story (max 50 words) to include the following words:-
trainer, muddy, marmalade, gravy, track, climate, medal, magician

SECTION "J" - YOUNG GARDENERS

Children can only enter classes in their correct age group – age of child as at 31st August 2021 to be quoted on all entry forms. Prizes for classes 1st - £2, 2nd - £1
A £5 prize will be presented to the exhibitor with the highest points total in each group in this section. The Royal Horticultural Society Junior Competitor's "Award of Merit" will be presented to the best exhibit in each age group

Group 5 – Ages up to 11 years

Class

- 210 Radishes, 3
- 211 Courgettes, 2, between 100mm and 150mm long
- 212 Runner Beans, 5
- 213 Lettuce, 1 with roots
- 214 Cress – exhibited in growth – NOT CUT
- 215 Any other vegetable not mentioned above
- 216 Tomatoes, 3

Group 6 – Ages 12 – 16

Class

- 217 Radishes, 3
- 218 Courgettes, 2, between 100mm and 150mm long
- 219 Runner Beans, 5
- 220 Lettuce, 1 with roots
- 221 Cress – exhibited in growth – NOT CUT
- 222 Any other vegetable not mentioned above
- 223 Tomatoes, 3

St Leonard's Church News

Website: www.uptonstleonardschurch.co.uk

Photo: published with kind permission of Sara Hemmings



Associate Priest: James Turk

Please note that due to James' work commitments, calls, texts and emails will be answered evenings and weekends

Priest in Charge: Vacancy

It was with great sadness we heard the news that HRH Prince Philip, Duke of Edinburgh passed away on 9th April. Our Tower Captain Charlie Burnett rung a single, half muffled church bell on Saturday 10th April at 12 noon to mark this occasion.

The following article was published by The Archbishop of Canterbury, Justin Welby,

"I join with the rest of the United Kingdom and the Commonwealth in mourning the loss of His Royal Highness Prince Philip, The Duke of Edinburgh, and give thanks to God for his extraordinary life of dedicated service. Prince Philip continually demonstrated his unfailing support and unstinting loyalty to Her Majesty The Queen for 73 years.

"He consistently put the interests of others ahead of his own and, in so doing, provided an outstanding example of Christian service. During his naval career, in which he served with distinction in the Second World War, he won the respect of his peers as an outstanding officer.

"On the occasions when I met him, I was always struck by his obvious joy at life, his enquiring mind and his ability to communicate to people from every background and walk of life. He was a master at putting people at their ease and making them feel special.

"The legacy he leaves is enormous. The Duke of Edinburgh's Award, which he founded in 1956, has inspired generations of young people to help others and instilled in them a vision for citizenship and a desire to serve their communities. His work with countless charities and organisations reflected his wide- ranging, global interests in topics including wildlife, sport, design, engineering and inter-faith dialogue.

"In his powerful advocacy for conservation his was a prophetic voice for over half a century, as he brought people from around the world to a new concern and commitment to action for the future of our planet.

"As we recover and rebuild after the terrible trial of the coronavirus pandemic, we will need fortitude and a deep sense of commitment to serving others. Throughout his life Prince Philip displayed those qualities in abundance, and I pray that we can take inspiration from his example.

"I also join many people in giving thanks for the marriage of Her Majesty the Queen and Prince Philip, and for their children, grandchildren and great-grandchildren. Theirs was a marriage grounded in friendship and mutual respect and sustained by shared faith in Christ.

"I pray that God will comfort Her Majesty and the rest of the Royal Family at this time. May His Royal Highness rest in peace and rise in glory."

The Old School Room



As the new year started my friend Sheila Thomas and I, after several visits to the disused schoolroom, decided we would take on this massive project, and try and resurrect a building that with a little work could come into active use again.

Firstly we had to clear out an awful lot of unwanted items. Boxes and boxes of craft materials were delivered to Upton School for use at the after school club.

Curtains were removed and washed, china all washed and boxed up ready for reuse, and we were

left with a shell of a leaking building with buckets everywhere, ceiling and walls covered in black grime after a time of not being used.

We set about cleaning and very soon realised the roof was a major problem. Once it had been professionally repaired and with the help of Martin and Jenny Innes pots of paint were everywhere. Our friend Eddie also joined in and all these kind people together with Keith Robbins and Mike Barnfield are still working away to help us when they can.

Now three months later and with a repaired floor kindly restored to its former glory by Bobbie Ramsay, one of our congregation, and with new windows in the kitchen things are definitely looking different. We are still painting and the outside has to be done as well, but I think I can now safely say we are half way through our project.

The amount of interest this has caused from friends and villagers dropping in on their walks has been both uplifting and amazing. We have also had expression of interest as to what we are doing with the hall.

The TLC choir made an amazing collection to help fill our coffers for the expenses we are incurring, as they wish to have their practice nights there. Who knows there may be a concert in the offing.

A member of our choir Anita Owen and her friend Diana have agreed to hold a garden party to raise funds for us (watch this space).

We have loads of ideas as to what we can do with the building once it is finished.

One major job to be undertaken is a complete re wire and new lighting and heating to be installed. This massive expense has only been made possible by a donation from a legacy left by Monica Sims to



ful. Pleasurable by the interest shown by everyone who has called in and if you haven't been to see us yet, please do. The stories are both interesting and enjoyable.

We are going to have an open day where everyone will be invited to help us

Gill Howell and Co.

Tower Floodlighting 2021

May 2021 the Tower lights will be lit for

1st May – Reginald William Crawford (Reg)

In memory of a wonderful, devoted & loving husband and father on the 1st May, whose birthday would have been on this day. Love & memories Julia and Barbara

May 15th The Church Tower Lights will be lit in remembrance of Jacky Harris on her birthday. Jacky lived in Upton St. Leonards for over 20 years and was very fond of the village and the many friends she made here. With love and so many happy memories from all her family

Clive and Julie Winstanley are sponsoring the Tower Lights on May 30th in celebration of their 40th Wedding Anniversary



Picture reproduced with kind permission of Corinne Bain

if you or your family would like to have the Church Tower Floodlights lit to celebrate a special event such as a birthday/anniversary/Baptism or in remembrance of a loved one please contact Jenny Cunningham for more details. There is no set amount for this, just what you would like to gift to the Church in order to help cover running costs. If you are able to Gift Aid your donation this will help us too.

Please note that the deadline for the Church Pages of USL Life is the 8th of the preceding month.



Thank you
to everyone who
contributed to the Easter
Egg collection for the Food
Bank.

The Food Bank is always
grateful for donations. A list
of items which are always
needed are on the
next page.

Readings for May 2021

May 2nd (tbc)

May 9th

Acts 10:44-end
John 15:9-17

Thursday 13th May Ascension Day

Acts 1:1-11
Luke 24:44-end)

May 16th

Acts 1:15-17, 21-end
John 17:6-19

May 23rd

Acts 2:1-21
John 14:25-27, 16 :4-15

May 30th

Romans 8:12-17
John 3:1-17



Who's Who in the Parish Church

Priest in Charge

Vacancy

Associate Priest:

Rev. James Turk

Churchwardens:

Gill Howell

Vacancy

PCC Secretary: - Sarah Kent

Church Treasurer

Vacancy

Baptism & Wedding Enquiries

Church Administrator - Jenny Cunningham

Safeguarding

Dorothy Cox

Bell Tower Captain

Charlie Burnett

Mother's Union:

Kate Gale

Church Cleaning Rota:

Claire Appleyard

Church Flowers:

Jenny Cunningham

USL Life (Church pages) and Pew News

Rachel Middleton

Gloucester Food Bank

Due to an increase of people having to downsize accommodation, there are a lot of people who are living in one room with only a kettle to cook with.

Urgently required are the following:

Tinned Fish
Tinned (cold style) Meats
Tinned Spaghetti
Tinned Fruit
Long Life Fruit Juice
Long Life Milk
Porridge Pots
Cup - a – Soups
Bottles of Squash
Bars of Soap
Single Toothbrushes
Toothpaste
Deodorant
Shampoo



Phase 2 of the Village Churchyard Update

I wrote last time that I was about to embark on what I describe as phase 2 of the churchyard survey work. I said that my starting point for phase 1 was the original survey, completed some 20 or so years ago I believe. This consisted of a table of around 1000 names, together with a map which had broken the churchyard down into a number of sections.

The churchyard map (all sections) was sub-divided to produce more detailed maps, some of which were of individual sections and some of which were combined sections, depending on the areas involved. The names on the graves in each section were given a number which was entered onto the appropriate section map and the table. I have copies of all of these.

As I reported last time, I have updated the basic information to include all burials back to 1540 and now have over 6,200 names. A lot of these are from records in ancestry, most of which seem to have been done on what I would describe as scraps of paper. Many are not easy to read. I have completed only very limited checking on those names.

However, from 1813 there are official burial registers which contain names, addresses, dates of burial (sometimes date of death) and age at time of death. These are presented in a much more structured way and easy to follow as a consequence. The location of the burial is also given on occasions in these Registers but only in general terms. These official Registers contain around 3200 names. I have copies of all the associated paperwork of the ancestry and Register names so it is possible to go back and review the information if necessary.



In terms of mapping, I decided that a numbering structure, used initially, would not work with potentially over 3,000 names to allocate. However, I did use the existing map to define the sections in the churchyard although I did

tweak the boundaries a little to make them more definitive to my eye. The map with these sections defined is shown here.

My strategy has been to define rows of graves. It was not immediately obvious that this would work but having walked over each section three or four times I found that it was not unreasonable. The rows were then added to the new sections maps.

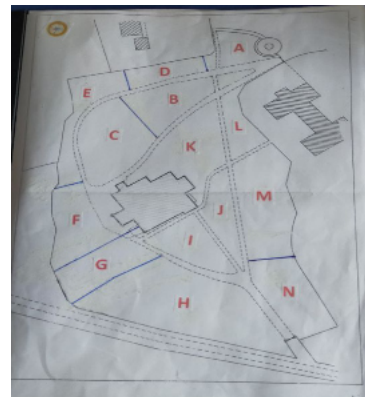

An example can be seen on the left.

The graves in each row were identified in order of left to right-facing in a defined direction and added to another spreadsheet. I now, therefore, have two spreadsheets:-

1.

The first is a list of all names broken down alphabetically by surname which also contains Christian names, dates of birth (if known), of death (again if known) and of burial from the appropriate record. The first column in each worksheet is the section where the grave is located. Ages at time of death are also given along with some generalised notes. These are not comprehensive in respect of what is inscribed. The source of the entry (that is which Register) is defined by colour.

2.

The second lists identified names in each section by section and then by row. Having identified the section location from the first spreadsheet, it is possible to identify which row they are in from this spreadsheet and then, by reference back to the maps, to find the location.

Continued overleaf on page 14

CHORLEY'S
 GLOUCESTERSHIRE'S FINE ART AUCTIONEERS
 Free auction valuations
 Regular fine art & antiques sales
 Insurance & probate valuations
 01452 344499
 enquiries@chorleys.com
 www.chorleys.com
 PRINKNASH ABBEY PARK GL4 8EU

Computer Playing up?

- Virus, Spyware, Malware removal
- Slow Computer
- Printer setup or fault
- Internet or wi-fi problem
- Data Recovery and Data Transfer service
- Software fault diagnosis
- Computer Tuition
- Computer Health Check
- FREE telephone support for minor problems

Call Churchdown Computers
 t: Mark on 01452 534668 or 07557 483438
 e: mark@churchdowncomputers.co.uk
 w: www.churchdowncomputers.co.uk

USL Village Store
 POST OFFICE
 Mon-Fri 7am-7pm
 Sat 7am-6pm
 Sun 7am-12pm

Your Village Store and Post Office
SHOP LOCAL
 We stock locally sourced fruit and veg, meat, milk, bakery goods and Fat Toni pizzas. Groceries, toiletries, snacks, sandwiches, drinks, cards and stationery and many more items.

SUPPORT LOCAL!
 Rahul and Seeta
 Churchfield Road 01452 618189

Phase 2 of the Village Churchyard Update cont'd

Many inscriptions are illegible – either because of weathering, because the colour of the lettering has disappeared (granite stones are the worst) or they are covered in moss/lichen. I shall have a go at reading these when the weather improves. Currently, they are simply entered in my spreadsheets as illegible. I shall have a go at cleaning the moss from those which have growth.

I met Andy R in the churchyard when I was on one of my expeditions recently. He advised that there was a time of day when the lettering on some stones was easier to read and that sometimes the use of a torch was beneficial. So, if you see someone down there at the dead of night, shining a light around the place, please shout to see if it is me before you telephone the police!

On my last trip, when I was trying to decipher a couple of granite stones I was joined by Jean and Maureen who were out for a walk. I explained what I was doing and they happily joined in polishing the stones and then, lo and behold, when the sun came out, it caught the letters perfectly so I was able to read them and cross two more off my list. I promised to acknowledge their efforts.

The oldest grave I have been able to find is that of Ann Robins who died 28th September 1643. Hers is the chest tomb immediately outside the church entrance, pictured below.



She was married to Henry but I have not been able to find out much more about them. A photograph of her tomb is shown above.

The next oldest is John Nurse who died 22nd May 1645. The most common name – you can guess - is Smith. There are 225 in my list.

Potentially, one of the most interesting inscriptions was that of Mary Armstrong whose grave is close to that of Lady Downe. When I first saw this I simply read “In her tongue was the law” which I thought was going a bit far. However, on inspection at a second visit, I found that I would have been slandering the lady because I had failed to read in the shadows “of kindness” which is from Proverbs 31:26 according to Google.

Finally, I took photographs of all the stones I could find – legible or not. These are arranged in order by section to correspond with the second spreadsheet. I have identified a photograph number against some names in the second spreadsheet to give guidance as to where to start looking should anyone want to see what the inscription on the stone is. There is more information there – I said above that I have listed only limited notes in the spreadsheet.

What next? Well, I am back golfing soon. I had planned to have these spreadsheets finished before then and I am largely there I think. I will work on the illegible stones when I can. I also have some old documents which I collected on my last trip to the vestry. These include the indenture (contract) of 15th August, 1630 for the lease of lands in Upton from John Robins et al to Richard Nason, for an annual rent of £7 of “lawful money of England”.

There is also at least one letter, among many, from Lady Downe. I will catalogue all of these documents and photograph them for the record. There are also memorials in the church which I have photographed and will add to my spreadsheet. Some of these are in the stained glass windows.

Phase 3 perhaps?

Compiled by Jeff Dawson



Rachel Harris
Dip CFHP MPSPract
Foot Health Practitioner
Home visits for all your footcare needs
Professional and courteous service
In the Gloucester area

07791 901 220
rachelh391@googlemail.com

MICHAEL TUCK
Your LOCAL ESTATE AGENT

SOLD IT!

FREE VALUATIONS CARRIED OUT
WITHIN 24 HRS IF REQUIRED

01452 612020
www.michaeltuck.co.uk

B.A. Electrical Services



Domestic & Commercial
Insured & Registered

For all your Electrical Needs
A Professional and Friendly Service
Quality Work at Competitive Prices
For a Free Estimate call Bernie
01594 368607 / 07881 981352

Our Feature Article this month is on Bats

We've almost reached the time of year for bats to start showing off their aerobatics. Their flying skill amazes me every year, swooping so close to me as I sit in the garden that I can occasionally hear their wings; despite the impression given in films and cartoons they never get caught in your hair. I often wonder how far they travel each night and whether they roost in Upton. I become more fascinated with each new thing I learn about them, for instance did you know they are the only mammals capable of controlled flight?

It's well known that bats hibernate through the winter but I have only recently learned that their body temperature drops as low as 5°C and their heart rate to only 10 beats per minute. I also hadn't realised they don't need to expend any energy when hanging upside down as their claws clamp shut automatically; it does however take considerable flying skill to actually land, a wing must be folded so they can manoeuvre to grab on upside down. As I'm writing this in February they have so little fat left, that on warmer nights they will venture out to feed. Through the next couple of months bats gradually begin to emerge, but if the weather turns cold again they go into a less extreme version of hibernation called torpor.

By May they are fully active, with the females starting to form maternity colonies and look for suitable nursery sites before giving birth to a single pup. Mating having taken place in September and October when the males of most species make purring, clicking, and buzzing sounds to attract the females; however the pups are conceived a few months after mating using a method called spermatozoa (storing of sperm inside the female's body until needed) and are born in June without fur and with eyes shut tight. For the first three weeks the pups strengthen their wings by holding tightly onto Mum and flapping vigorously, after that they are able to move onto practising flying around inside their nursery roosts. After six weeks the nurseries are emptying as the pups are weaned and hunting for themselves.



Great Britain is home to seventeen species of bats; both bats and their homes are protected by a law passed in 1981. The numbers of all bats declined throughout the 20th century, with the Greater

Horseshoe Bat population going down by 90%. Populations are slow to build again due to the changing landscape of our urban, industrial, and country areas. At

one conservation site in Dorset support and close monitoring has resulted in the numbers of the Greater Horseshoe increasing from 100 to possibly 400 between 1994 and 2019.

The Common Pipistrelle is our smallest bat weighing 3-8g and can fit inside a matchbox, though it is sadly not as common as its name implies. That also means I wasn't able to find a photograph to publish so it was suggested by bat conservationist Nils Bouillard to use a photograph of the Long Eared Bat as they look really cute. Both these bats are ones we are likely to see flying around this area; I think it may be the Common Pipistrelle I see as its flight is rapid with lots of twists and turns, whereas the Long Eared Bat has a relatively slow, fluttery flight.



Bats across the world play a vital role in pest management, saving farmers billions of pounds and therefore unwittingly playing a part in reducing the use of chemical pesticides. The future may hold another good reason for us to be extremely grateful to bats, as scientists are currently studying them to see if there is a way to emulate their immune systems. Also research with the visually impaired at Durham University is proving humans are capable of using echolocation to navigate the world. In Mexico, bats provide a vital service by pollinating the agave plant from which tequila is made, so those of you who enjoy a margarita, a chimayo, a paloma, or a sangrita have yet another reason to appreciate them.

Bats echolocation skills are phenomenal so I wonder how, many years ago, one ended up in a plastic carrier bag in our garage causing us think we had mice! It was such a tiny and cute creature that once we recovered from the shock we very carefully placed it in a tree.

One last interesting thing at a time where face masks have become a part of daily life is that the Wrinkle-Faced Bats of Central America cover the lower half of their faces with white furred flaps of skin that resemble masks, before singing their ultrasonic songs.

Written by Jane Read

Sources

Bats Conservation Trust – www.bats.org.uk
Sunday Telegraph & Sunday Mail
BBC - "Out Of The Batcave"
The Wildlife Trusts – www.wildlifetrusts.org
Images – Nils Bouillard

USL Life Arts Page May 2021

We will focus this month on Women and how poets have named and portrayed them.

They are Annabel Lee, Maud, Julia, Prewdence and Andromeda

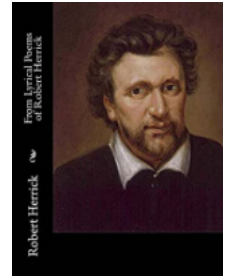

Annabel Lee by Edgar Allan Poe 1809 – 1849

It was many and many a year ago,
In a kingdom by the sea
That a maiden there lived whom you may know
By the name of ANNABEL LEE;
And this maiden she lived with no other thought
Than to love and be loved by me.

And this was the reason that, long ago,
In this kingdom by the sea,
A wind blew out of a cloud, chilling
My beautiful ANNABEL LEE;
So that her highborn kinsmen came
And bore her away from me,
To shut her up in a sepulchre
In this kingdom by the sea.

But our love was stronger by far than the love
Of those who were older than we –
Of many far wiser than we –
And neither the angels in heaven above,
Nor the demons down under the sea,
Can ever dissever my soul from the soul
Of the beautiful ANNABEL LEE;

Maud by Alfred Tennyson 1809 – 1892 (there are 156 verses – here are two)

Come into the garden, Maud,
For the black bat, night, has flown,
Come into the garden, Maud,
I am here at the gate alone;
And the woodbine spices are wafted abroad,
And the musk of the rose is blown.

For a breeze of morning moves,
And the planet of Love is on high,
Beginning to faint in the light that she loves
On a bed of daffodil sky,
To faint in the light of the sun she loves,
To faint in his light and to die.

Socrates wrote that "Beauty is a short lived reign" and John Dryden suggested that "All heiresses are beautiful".

According to Lord Byron, "Wives in their husbands' absences grow subtler and daughters sometimes run off with the butler".

Three short poems by Robert Herrick 1591 – 1674

Upon Julia's voice

So smooth, so sweet, so silv'ry is thy voice,
As, could they hear, the dam'd would make no noise,
But listen to thee, (walking in thy chamber)
Melting melodious words, to Lutes of Amber

To Julia

Julia, when thy Herrick dies,
Close thou up thy Poets eyes,
And his last breath, let it be
Taken in by none but Thee.

Upon Prew his Maid

In this little Urne is laid
Prewdence Baldwin (once my maid)
From whose happy spark here let
Spring the purple Violet,

Andromeda by Sappho

I hear that Andromeda -
That hayseed in her hayseed finery
Has put a torch to your heart

And she without even
The art of lifting her
Skirt over her ankles

Translated by Mary Barnard

BOOK REVIEW

Jane Eyre is a novel by English writer Charlotte Bronte, published in 1847. It is set in Northern England and covers many themes including the role of the family, religion, social status and love and marriage.



Along with *Pride and Prejudice* by Jane Austen *Jane Eyre* is one of the most famous romance novels of all time. You probably read it long ago – we recommend that you read it again or listen to it as an audio book. There have been many films made of this novel too, along with sequels, a prequel and re-tellings.

Spring and Health



May is the last month in Spring and one we should make the most of, with warmer weather tempting us outdoors for longer periods, longer evenings enticing us to stay active for longer and spending less time watching TV. We can relish meeting up with loved ones and re-awakening our social lives.

Our health has become a focus in the last year due to the pandemic and we now hear that another one may come along in the next 10 years, so best to be prepared and use this time to focus on improving our health and immunity.

A fabulous website has been launched by the wonderful health care professionals at Aspen Medical Practice at:



www.eatrealfood.uk/homepage

Here you can learn all about what we eat and how it affects our health. Also, we can see what we feed our family and the impact it has

on how they grow and develop.

This is an easy way to educate yourself with bitesize pieces of information on Eat Real Food. You can watch short videos on Eat Real Food bitesize, most less than 10 mins in length. This is a great way to learn about health and wellbeing and the four pillars of health.

Food
Movement
Sleep
Stress



Now, through the world wide web, we have the means to educate ourselves in the comfort of our own homes, in our own time.

“What you find at the end of your fork is more powerful than anything you’ll find at the

bottom of a pill bottle” – Mark Hyman

Following feedback from the very successful “Let’s Talk About Health” programme, I have been asked to run a weekly support group on Zoom.

This will be Thursday evenings at 7.30 pm every week so you can drop in as it suits your diary. This is for anyone who wants to improve their health one meal at a time. It demonstrates how you can lose weight without hunger and reverse Type 2 Diabetes and enable Type 1 Diabetics to have more time in range and reduce the high and low blood glucose levels you can get with eating higher levels of carbohydrates.

Real Food allows us to reduce our blood pressure and improve our health through lifestyle changes.

Zoom sessions are booked weekly until Christmas so drop in when you can, leave early if you need to, listen in and learn all about how nutrition and health go hand in hand.

Millie Barnes

Freestyle Libre are offering a 14 day continuous blood glucose monitor, this is for anyone who has:

Diabetes Type 1 or Type 2.

Apply online at:

<https://sample.freestyle.abbott/gb-en/freestylelibre/sign-up.html>

If you need advice on its use contact Millie



Village Diary

Please note, these details are still provisional due to coronavirus.

MAY

1	Sat	Cricket USL 2 nd X1 v Ruardean Hill 2 nd X1	Recreation ground	
2	Sun	Tennis	Pavilion	10.00a.m.
3	Mon	Bank Holiday		
4	Tues	Rubbish and food waste week. Garden rubbish for those with brown bins.		
4	Tues	Tennis	Pavilion	6.00p.m.
6	Thu	Local Elections	Village Hall	7.00a.m.-10.00p.m.
9	Sun	Tennis	Pavilion	10.00a.m.
10	Mon	Parish Council Meeting	Pavilion or via zoom	7.30p.m.
10	Mon	Copy date for June issue of USL Life		
11	Tues	Recycling and food waste week		
11	Tues	Tennis	Pavilion	6.00p.m.
16	Sun	Tennis	Pavilion	10.00a.m.
18	Tues	Rubbish and food waste week. Garden rubbish for those with brown bins		
23	Sun	Tennis	Pavilion	10.00a.m.
24	Mon	Lady Downe Trustees meeting (to be advised)	Upton St Leonards School	7.30p.m.
25	Tues	Recycling and food waste week		
30	Sun	Tennis	Pavilion	10.00a.m.
31	Mon	Spring Bank Holiday		

JUNE

7	Mon	Parish Council Meeting	Pavilion or zoom	7.30p.m.
10	Thu	Copy date for July issue of USL Life		

JULY

5	Mon	Parish Council Meeting	Pavilion	7.30p.m.
10	Sat	Copy date for August issue of USL Life		

To place an entry in the Village Diary, please contact Paula Quinn

Temporary Closure of the B4073 Gloucester Road, Painswick



This road will be closed from its junction with the road to Painswick Beacon to outside the entrance to the property known as Cud Hill House for a distance of approximately 780 metres.

The road is expected to be closed between the hours of 09:30 and 15:30 from 12th May 2021 until 14 May 2021 only or until the works have been completed.

The reason for the closure is to enable safe access to overhead network cables in order for new cabling works to be undertaken.

For further information, please contact Gloucestershire Highways on 08000 514 514 or visit www.gloucestershire.gov.uk.

Alternative Route – as signed on site.



J.B. RD
CHIMNEY SWEEP

Traditional and Power Chimney Sweeping from £40

Open Fires, Boilers, Cookers and Stoves Serviced

Chimney Pots, Cowls and Bird Guards Fitted

Flue Liners and Stoves Installed to Latest Regulations

Cctv Chimney Camera Surveys

PHONE ME TODAY FOR AN APPOINTMENT

01452 521732
07973 905151

sootybloke@blueyonder.co.uk



Obituary - Barbara Wait 1921 - 2021



Barbara passed away peacefully at home in Perry Orchard, Upton St Leonards, aged 99. She is survived by her granddaughters Jasmine, Amy and Charlotte. She had lived in Perry Orchard since the properties were built in the 1960s, was an active member of the local branch of the War Widows Association and until recently, was a member of the church, the WI and the Mother's Union.

She worked as a school secretary at Selwyn School in Matson and her granddaughters both attended Upton Primary School and were married at Upton Church. Her granddaughters, to whom she was very close, have many memories of her from the past, of a house filled with flowers, glamorous parties and much fun and laughter.

Barbara had an extraordinary life, in part due to the losses she suffered and survived. From the premature death of her father, when she was 12, to the loss of her husband Captain Douglas Jose Collins, of the 4th/7th Royal Dragoon Guards who was killed in action following the D-Day landings on 1st August 1944 when her daughter Penny was just a year old; her second husband William Robson Wait in 1970, whose ashes are buried in Upton Church and both her daughters, Victoria in 1951 and Penny in 2019.

Her strength and spirit took her on her life journey from one experience to the next and she meant so much to so many people along the way and they to her.

Her granddaughters would like to thank her neighbours and friends in Perry Orchard for their support and messages of sympathy and in particular Carrie Leighton and Eddie and Linda Spence for everything they did to help her maintain her independence and remain in her own home until the end.

Notices



The Upstagers Drama Group are looking for new people to join them.

When: Every Wednesday, 7.30 pm in the Village Hall.

For more information email upstagers at hotmail.com



Tuesday nights are proving to be very popular down on the tennis courts! A booking system is in place and even despite the 'freezing' conditions on 6 April both courts were occupied, with others eagerly awaiting their turn.

For further information please contact Rod Kirkpatrick



Congratulations to Richard and Sue Merigold on their Golden Wedding Anniversary on 12 April and also to Clive and Julie Winstanley who celebrate their Ruby Wedding Anniversary on 30 May.

UPTON ST LEONARDS LIFE

Web site: <http://usllife.org.uk>

To contact us, use the website above or the postbox by the Village Hall main door, or use the contact details that appear below:

This month's editor: Andrea Dawson
 Editors: Andrea Dawson
 Andy Russell
 Barbara Swindin
 Peter Wilson

Company Secretary: Cliff Alderman

Treasurer: Owen Stinchcombe

Feature writers: Christina Caldwell
 Linda Munnoch
 Ann Morphew
 Jane Reed

Church pages: Rachel Middleton

Clubs / Societies / Organisations: Catherine McLean

Diary: Paula Quinn

Advertising: Contact: Andy Russell

Admin Support: Janine Black

Distribution: Jenny Cunningham

Photography: Jim Browne

Proof Readers: Carol Hardacre
 Pam Tickner
 Kate Davies

USL Life is published by USL Life CIC, a Limited Company, and is printed at Pip Printing, Nettle of Hereford.

Next month's editor

Andy Russell



Contact via the postbox at the Village Hall or via the "Contact Us" box on our web page

DISCLAIMER: USL Life welcomes adverts for goods and services but reminds readers to make their own checks before entering into any contract or other arrangements with advertisers, as USL Life cannot be held responsible for the accuracy of the advertisements.

A Few of the Easter Window Scenes in support of USL Primary School

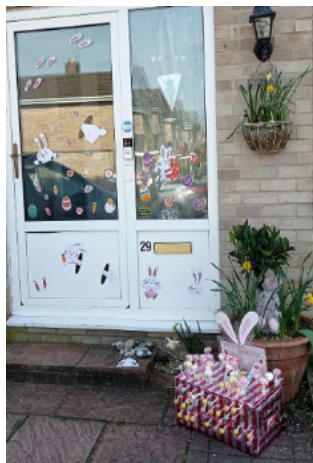

A big thank you to this participant in Woodland Green for providing so many lovely lollies for the children.



Six of our Newsletter team meet up face to face for the first time in 2021, the Editor is behind the lens!

Hot drinks and hot cross buns all helped to stimulate the creative juices, which we hope you continue to enjoy in this May issue.